

Documents corresponding to the product:

Standard EN 62 208;
EN 60439-1; EN 60 439-3

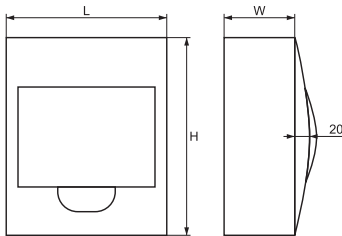

Plastic distribution boxes for surface and flush mounting IP40

3 YEAR WARRANTY

The distribution boxes are designed for mounting in newly built buildings or buildings in reconstruction. They are a module box with mounted protective devices of the given flats electrical current circuit circles. They are supplied with transparent door for each row opening upwards to 90°. They are made of white self-extinguishing plastic, resistant to heat and high temperature with IP code: IP 40. The mounted device in the box is protected from direct contact to the current leading parts. They are offered with DIN-rail for device mounting and terminal strips for the neutral and earthing conductor joining. Mounted directly on the walls with screws.

Technical data:

- Maximum insulation voltage: 690V; 50Hz
- fire resistance rate: UL 94
- IP code: IP 40
- Class of current limiting: 2

Boxes for surface mounting

Number of rows	Module capacity (number of devices)	Dimensions (mm)			Packing / Box	Catalogue number
		L	H	W		
1	4	110	205	75	1 / 20	60040
1	6	150	205	75	1 / 20	60060
1	8	190	205	75	1 / 20	60080

Boxes for flush mounting

Number of rows	Module capacity (number of devices)	Dimensions (mm)			Packing / Box	Catalogue number
		L	H	W		
1	4	110	205	75	1 / 20	60041
1	6	150	205	75	1 / 20	60061
1	8	190	205	75	1 / 20	60081



Plastic distribution boards

Documents corresponding to the product:

Standard EN 62 208;
EN 60439-1; EN 60 439-3



Plastic distribution boxes for surface and flush mounting IP40

3 YEAR WARRANTY

The distribution boxes are designed for mounting in newly built buildings or buildings in reconstruction. They are a module box with mounted protective devices of the given flats electrical current circuit circles. They are supplied with transparent door for each row opening upwards to 90°. They are made of white self-extinguishing plastic, resistant to heat and high temperature with IP code: IP 40. The mounted device in the box is protected from direct contact to the current leading parts. They are offered with DIN-rail for device mounting and terminal strips for the neutral and earthing conductor joining. Mounted directly on the walls with screws.

Technical data:

- Door colour: Transparent blue
- Mounting type: Surface; Flush
- Modules (N°): 12; 18; 24; 28; 36
- IP code: IP30
- Row: Single row for 12 and 18 modules
- Double rows for 24; 28 and 36 modules
- Material: ABS for body and PC for door
- Fire resistance: 650°C/30s
- Ambient temperature(°C): -5 +65°C, max. 95% humidity
- Colour: White RAL 9003
- Storage temperature(°C): -40 +75°C

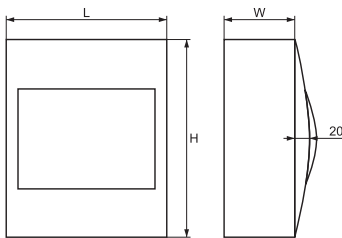

Boxes for surface mounting

Number of rows	Module capacity (number of devices)	Dimensions (mm)			Packing / Box	Catalogue number
		L	H	W		
1	12	300	204	102	1/10	60122
1	18	410	204	102	1/10	60182
2	24	300	294	109	1/5	60242
2	28	310	354	109	1/5	60282
2	36	410	294	109	1/5	60362

Boxes for flush mounting

Number of rows	Module capacity (number of devices)	Dimensions (mm)			Packing / Box	Catalogue number
		L	H	W		
1	12	317	220	102	1/10	60123
1	18	426	220	102	1/10	60183
2	24	317	310	109	1/5	60243
2	28	294	338	109	1/5	60283
2	36	426	310	109	1/5	60363

